

A/19332/712/95
 Planning Permit No. _____
APPROVED
 SUBJECT TO THE CONDITIONS IN THIS OFFICE LETTER.
 No. A/22596/95 Dated 11-95
 FOR MEMBER SECRETARY
 MADRAS METROPOLITAN
 DEVELOPMENT AUTHORITY
 MADRAS - 600 008.

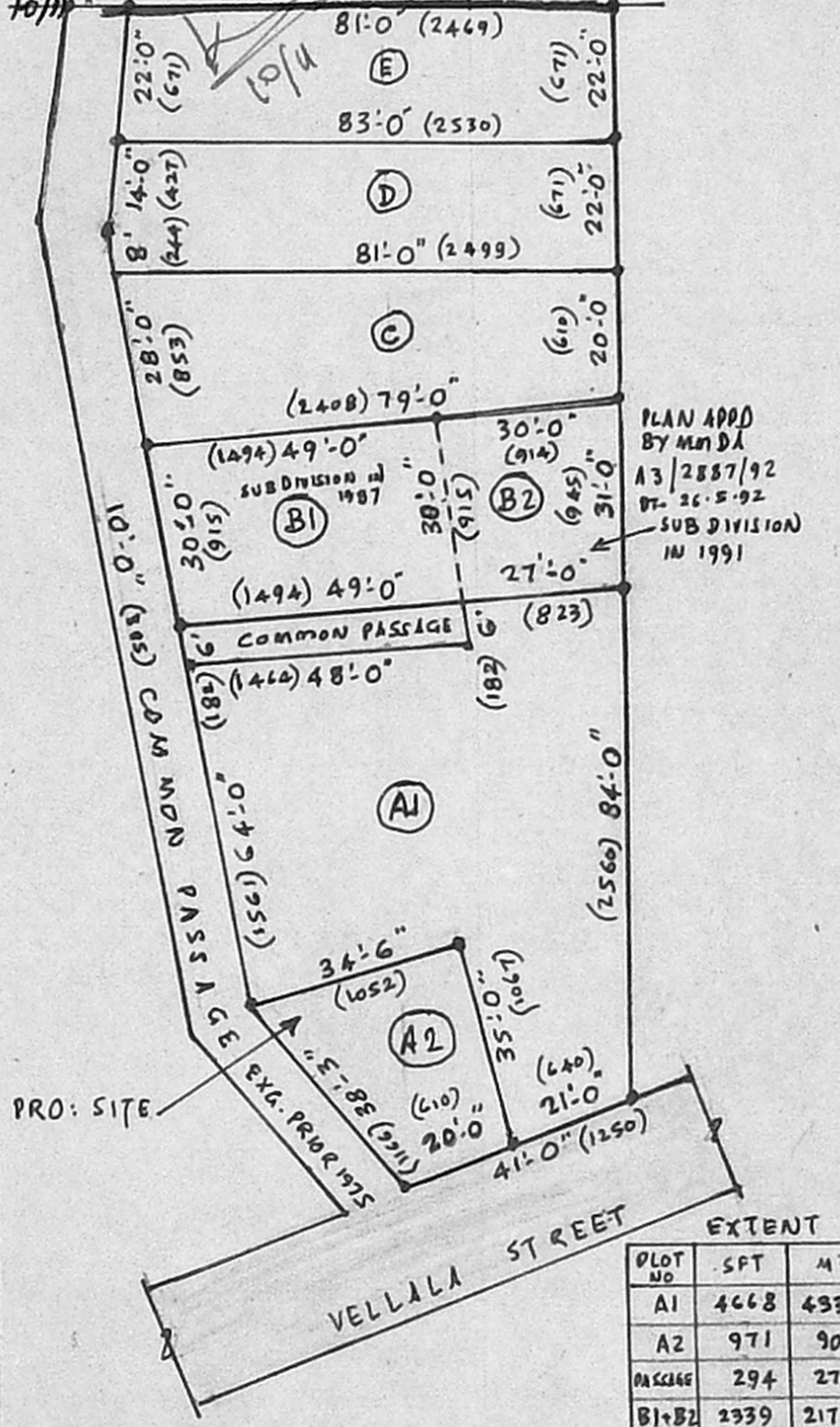

Plot No	SFT	M ²
A1	4668	433.7
A2	971	90.2
PASSAGE	294	27.3
B1+B2	2339	217.3
C	1932	179.5
D	1804	167.4
E	1804	167.4
TOTAL	13812	1283.2

PLAN SHOWING THE PROPOSED RESIDENCE AT 63 VELLALA STREET, T.S. NO. 2/11 OF BLOCK NO. 11 OF NYANAVARAM, DIVISION NO. 56, CORPORATION OF MADRAS. SCALE: 1" = 8'-0" (1cm = 100cm)

PROPOSED WORK ROADS SITE BOUNDARY

SPECIFICATION:
 PCC 1:4:8; RCC 1:4:8; BRICK WORK IN CM 1:6; PLASTERING WALLS 1/2 TH. IN CM 1:3; CEILING 1/2 TH. IN CM 1:3; FLOORING 3/4 TH. IN CM 1:3; W.P.C. 4" WITH 1 COURSE TILES SET IN CM 1:3.
 DOORS: D1: 3'-3" X 7'-0" (100 X 212) D2: 3'-0" X 7'-0" (91 X 212) D3: 2'-6" X 7'-0" (76 X 212)
 WINDOWS: W1: 4'-6" X 4'-6" (137 X 137) W2: 4'-0" X 3'-0" (122 X 91) W3: 3'-0" X 4'-6" (91 X 137)
 VENTILATOR: V: 3'-0" X 2'-0" (91 X 61) WARDROBE: WR: 3'-0" X 7'-0" (91 X 212)
 PLOT AREA: 971 SFT (90.2 M²) PC: 51% FSI: 0.98
 PLINTH AREA: GF: 496 SFT (46.1 M²) FF: 448 SFT (41.6 M²)

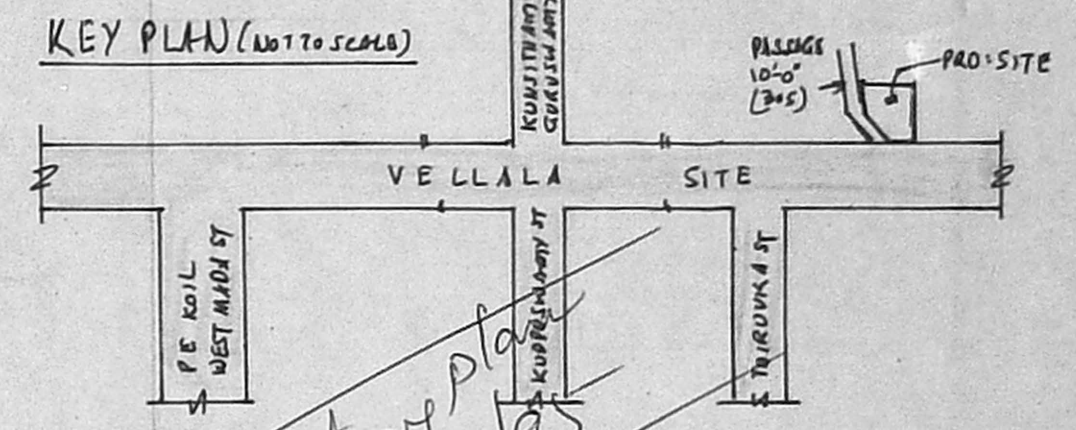

Scouting plan
 A/22596/95
 9/10/95
 M. S. SENTHIL KUMAR, M.E. (STRUCT)
 LICENCED SURVEYOR CLASS-I
 CORPORATION OF MADRAS,
 LICENCE NO: 406.
 53, MEDAVAKKAM TANK ROAD,
 KILPAUK, MADRAS 10
 (OPP. TO MENTAL HOSPITAL I)

OWNER: TMT. G. LAKSHMI